

Rinse ACE® MY OWN SHOWER® System

A better shower in a snap.®

MY OWN SHOWER® Connector - One-time Installation:

1. (A) Remove your showerhead. Adjustable wrench or pliers may be needed to remove showerhead. To prevent scratching, always cover parts with a cloth before using a wrench or pliers.
2. (B) Wrap pipe threads with the enclosed Teflon® tape. This produces a better seal and prevents possible leaking. Twist RINSE ACE® Connector onto your shower pipe. Exposed threads will not affect the seal. The Rinse Ace® Connector should twist on easily by hand. If you have difficulty, remove the Rinse Ace® Connector, change the angle to align the threads and try again. **DO NOT FORCE THE CONNECTOR** this could strip the Connector threads. Hand-tighten only to prevent damaging the Connector.
3. Wrap the Rinse Ace® Connector threads with the enclosed Teflon® tape. Reattach the showerhead - **DO NOT FORCE**. Exposed threads on the Rinse Ace® Connector will not affect the seal. Hand-tightening is sufficient.

See easy installation and use video at: <http://bit.ly/kQA0Gi>

To Use MY OWN SHOWER® Showerhead:

1. (C) Attach the My Own Shower hose by aligning the tabs on hose end with notches in Rinse Ace® Connector opening. Push in and twist clockwise to lock. *Water will not come through the "adult" showerhead when the hose is attached.*
2. Place My Own Showerhead® on the wall with suction cups. Turn on shower and adjust water temperature for your child's comfort.
3. When shower is over, turn off water, twist the hose counterclockwise to unlock and pull straight out. Drain remaining water from hose and coil for easy storage. Remove My Own Shower® suction cups by lifting on their tabs.

Helpful Hints:

- Prior to its first use, the hose will maintain the shape of its packaging. Before using My Own Shower® Showerhead with a child, run hot water through the hose to make it more pliable and easy to handle.
- The showerhead swivels at the hose. The showerhead suction cup should be parallel to the wall before placing suction cup on the wall.
- The suction cups need a smooth, clean surface to hold in place. Do not position suction cups on a grout line. Moistening the rim of the suction cups can help make a better seal.
- The character and showerhead suction cup are designed to "break away" and can be put back together without affecting performance. The character will slide back on over the showerhead and the suction cup can be pushed over the notch on the back of the showerhead. Remove My Own Shower® suction cups by lifting on their tabs.

Register your purchase at www.rinseace.com/service/product-registration/

One Year Warranty:

Idea Factory, Inc. warrants this product shall be free of defects in assembly under normal use when properly installed and maintained in accordance with instructions. This warranty does not include damage to the product resulting from misuse, product alteration or improper care and maintenance. This warranty gives you specific legal rights, and you may also have rights that vary from state to state.

If the product should become defective, Idea Factory, Inc. will repair it or elect to replace it free of charge. To obtain warranty service, email consumerassist@ideafactoryinc.com or call (800)867-4673. You may be instructed to return defective product, postage prepaid, to:

Consumer Assistance • Idea Factory, Inc. • N56 W16865 Ridgewood Dr., Suite 200 • Menomonee Falls, WI 53051-5656

Include a return shipping address inside the package. Idea Factory, Inc., will return your product postage prepaid. Allow 2 weeks for delivery.

Not responsible for illegible, lost or misdirected mail. Claims of non-receipt will require you to provide a photocopy of substantiation of your shipment to Idea Factory, Inc.

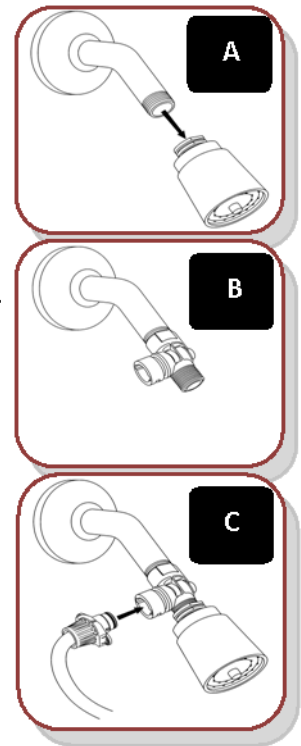

ideafactory inc